

Owner: State of Hawaii
(Richard Smart) i.e.
Portion of G.L. 3358

Owner
Richard Smart

Owner
Hawaiian Homes Land
(Richard Smart) i.e.
G.L. 3357

TRUE NORTH
SCALE: 1 in. = 200 FT.

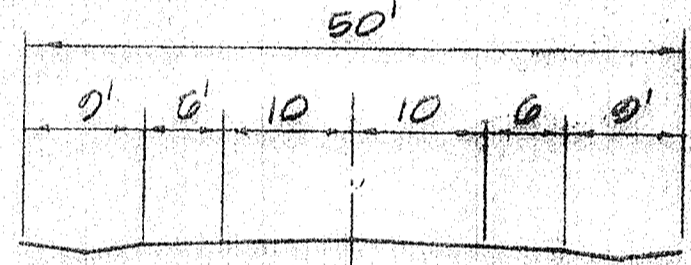
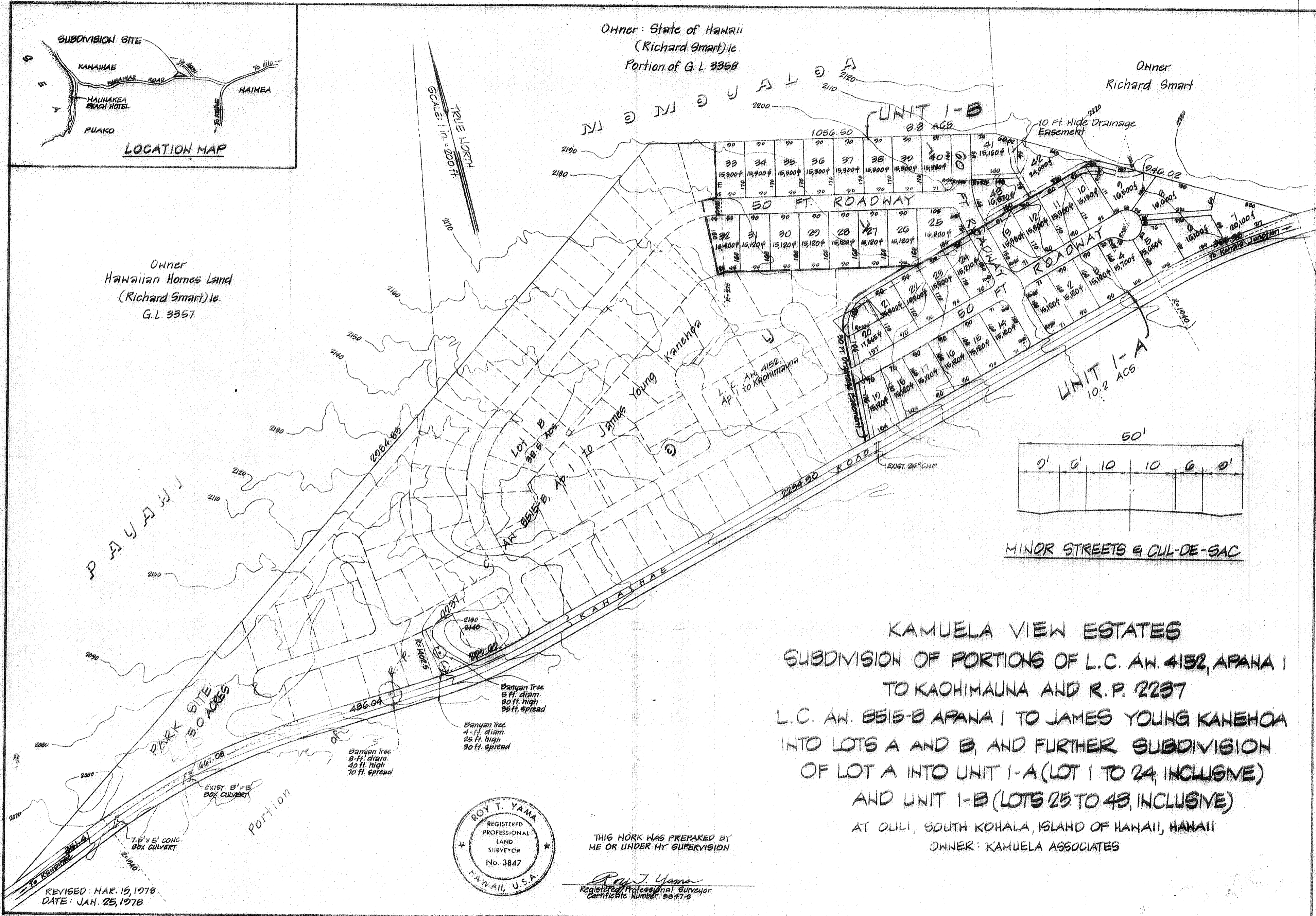

KAMUELA VIEW ESTATES
 SUBDIVISION OF PORTIONS OF L.C. AN. 4152, APANA 1
 TO KAOHIMAUNA AND R.P. 2237
 L.C. AN. 8515-B APANA 1 TO JAMES YOUNG KANEHOA
 INTO LOTS A AND B, AND FURTHER SUBDIVISION
 OF LOT A INTO UNIT 1-A (LOT 1 TO 24, INCLUSIVE)
 AND UNIT 1-B (LOTS 25 TO 43, INCLUSIVE)
 AT OULI, SOUTH KOHALA, ISLAND OF HAWAII, HAWAII
 OWNER: KAMUELA ASSOCIATES

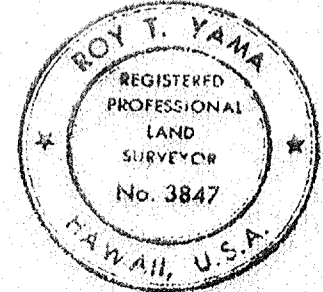

THIS WORK WAS PREPARED BY
ME OR UNDER MY SUPERVISION

Roy T. Yama
Registered Professional Surveyor
Certificate Number: 3847-S

PARK ENGINEERING, INC.
PACIFIC TRADE CENTER SUITE 2085
190 S. KING ST. HONOLULU HAWAII

REVISED: MAR. 15, 1978
DATE: JAN. 25, 1978

TAX MAP KEY: G-2-01-10 & 08, 5th DIV.